

concept 2 MODEL D SCHEMATIC
INDOOR ROWER

For Model D Indoor Rowers
made **AFTER** July 31, 2006

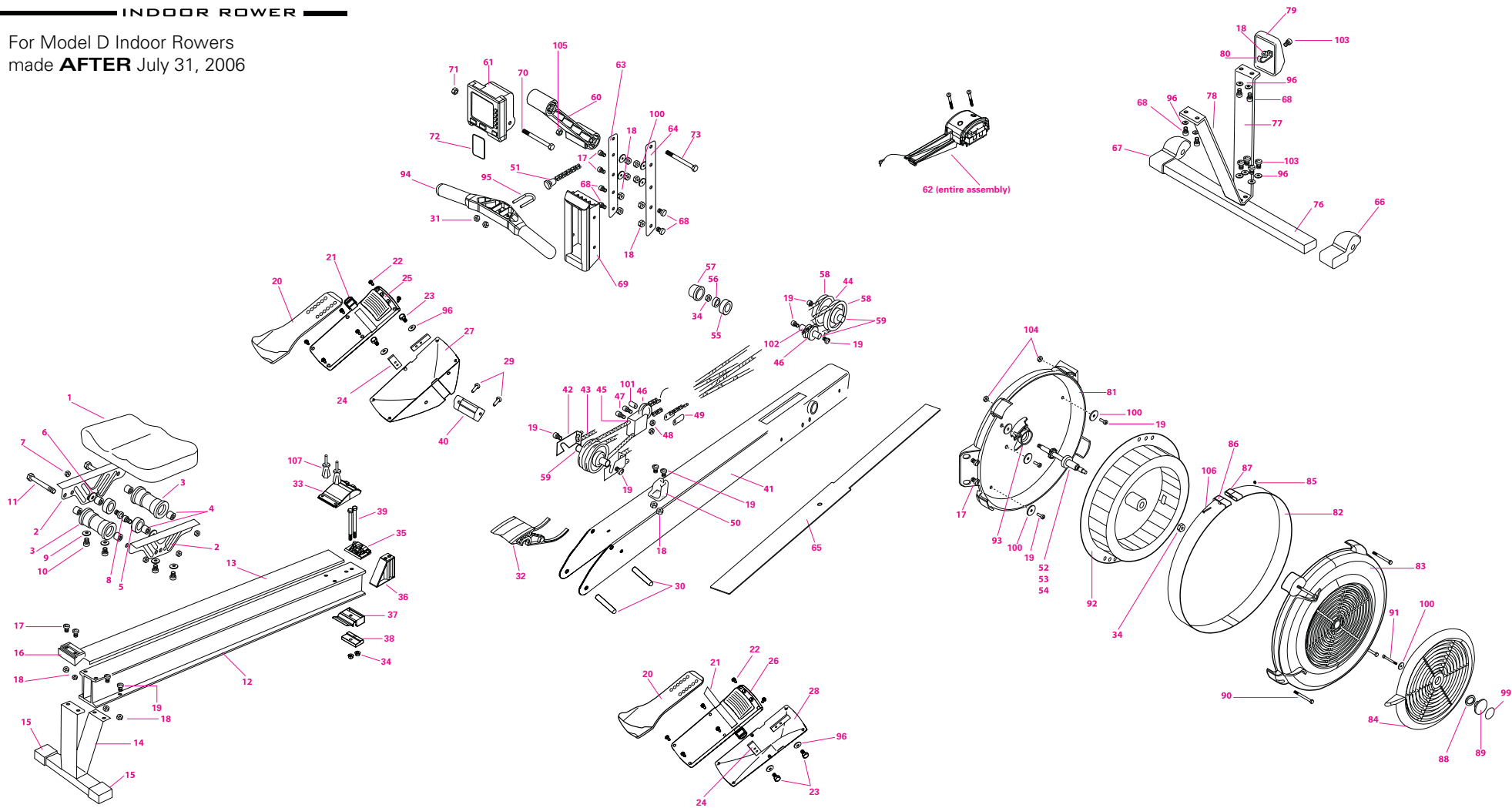



Model D Part Identification List
- for rowers made **AFTER** 07/31/06

	PN	Description			
1	1929	Seat Top w/Screws	50	1058	Handle Hook Model D2/E
2	1138	Seat Carriage Left	51	1716	Chain with Connector and Swivel
	1137	Seat Carriage Right	52	1165	Axle D/E
3	1724	Top Roller	53	1163	Sprocket Quiet 14 Tooth D/E
4	1302	Seat Spacer	54	1300	17mm Bearing
5	1725	Bottom Roller	55	1013	R8 Bearing Cup
6	125	Washer 3/8	56	232	Bearing R8 ZZ B/C/D/E
7	1209	Nut 3/8 - 16 BC Nylock	57	1010	Bearing Cover
8	1208	Screw 3/8 - 16 x 1.25 Low Profile SH	58	1011	Shock Cord Pulley
9	1246	#10 External Lock Washer	59	1130	Axle Shock Cord/Chain Idler Pulley x 3
10	1207	Screw SL HWMS 10/24 x 1/2 Patch	60	1025	Monitor Arm Black
11	1211	Screw 3/8 - 16 x 4.5 BC	61	1874	PM3 Monitor RoHS
12	1954	Monorail Assy D w/Track	62	1887	Power Generator Assembly
13	1762	Track/Tape Assembly w/Rivet	63	1168	Guide Bracket Left
14	1951	Rear Leg Model D2 w/Feet	64	1169	Guide Bracket Right
15	1044	Rear Foot D2/E	65	1526	Return Mechanism Cover
16	1008	Rear Bumper	66	1059	Footcaster Right
17	1201	Buttonhead Screw 1/4 - 20 x 3/4 SS Patch C/D/E	67	1060	Footcaster Left
18	1213	Nut 1/4 - 20 ZP	68	1253	Buttonhead Screw 1/4 - 20 x 5/8 SS C/D/E
19	1231	Buttonhead Screw 1/4 - 20 x 1/2 SS Patch C/D/E	69	1003	Chain Guide
20	1063	Flexfoot Grey D2 & E	70	1268	HCS 3/8 x 3 SS Waxed
21	1517	Footstrap with Buckle (one per side)	71	1271	Hexnut 3/8 - 16 SS
22	1241	10 x 1/2 TFS screw	72	1810	Logcard with Sleeve
23	1243	1/4 - 20 x 5/8 HCS GR .5 ZP	73	1266	HSC 3/8 x 4 SS
24	1139	Reinforcing Bracket (two per side)	76	1925	Front Foot w/Casters
25	1055	Cover Foot Stretcher Left	77	1173	Leg Front Long D
26	1054	Cover Foot Stretcher Right	78	1172	Leg Front Short D
27	1057	Belly Left Footstretcher	79	1009	End Cap
28	1056	Belly Right Footstretcher	80	1131	End Cap Hook
29	1242	10 x 3/4 TFS screw	81	1031	Flywheel Cover Back D
30	1101	Hanger Shaft Threaded	82	1912	Outlet Perf w/Connectors and Screw Assy. D
31	1235	Nut 1/4 - 20 Nylock SS	83	1943	Fan Cover Assy. D
32	1041	Mouse	84	1061	Damper D2 / E
33	1038	Upper Hanger Plastic	85	1275	#6 Nut Stainless Steel
34	1244	Nut 3/8 - 16 ZP Nylock Zinc	86	1035	Perf Connector Screw Side
35	1153	Upper Die Cast Hanger	87	1036	Perf Connector Nut Side
36	1062	Monorail Bolt Support	88	1278	Wave Washer
37	1039	Lower Hanger Plastic	89	1067	Hub Cap Model D2 / E
38	1154	Lower Die Cast Hanger	90	1276	Flywheel Cover Bolt 10 x 3 Pan PH SS (x4)
39	1204	Screw 3/8 - 16 x 5.5 ZP GR5	91	1273	Damper Screw 10 x 3/4 Pan PH Type B SS
40	1037	Compression Member	92	1940	Flywheel Assembly (machine made prior to 10/30/06)
41	1129	Box Frame D2		2940	Flywheel Assembly (machine made 10/30/06 or later)
42	1104	SCAM	93	1012	17mm Bearing Rubber Cup
43	1731	Shock Cord	94	1042	Handle
44	1310	SC Pulley Spacer	95	244	U Bolt
45	1756	Traveling Pulley Assy C/D/E	96	1205	Lock Washers (8)
46	1024	Chain Idler Pulley	99	1534	Hubcap label
47	1206	Traveling Pulley Screws (x2)	100	1232	Fender Washer 1/4 x 1 1/4 BX
48	1249	1/4 Nylock Jam Nut (x2)	101	1303	Traveling Pulley Spacer
49	285	Chain Connector Small	102	1305	Idler Pulley Spacer (x2)
			103	1248	Screw 1/4 - 20 3/4 SS Buttonhead C/D/E
			104	327	Nut #10 SS (4)
			105	1270	Nylock 3/8 - 16 SS
			106	1274	Pan PH #6 x 2 SS
			107	1251	Poly Rivet x 2